

# DRAWER Marine Refrigerators & Freezers

*When refrigeration makes a design difference!*



## Some configuration options:

- Different side frames: 3 to 4 side frames available in order to obtain flush-mounted installation
- Different cooling systems: ventilated as standard, water-cooled with a self-pumping kit (patented) and water-cooled through a sea water pump for tropical conditions
- Universal kit AC/DC optional: allows sufficient power supply all over the world
- Customised frames for side by side applications
- The innovative Isotherm off shore lock prevents the door from being opened accidentally

## Frost-free – Award winning technology

- Exclusive Indel Webasto Marine technology for the marine market
- No ice accumulation for an excellent efficiency increase
- Exceptional cooling achievement: the refrigerator and the freezer reach the set temperature faster
- Stable inside temperature
- Manual defrosting becomes redundant
- No more unpleasant water pools resulting from incorrect manual defrosting



Available on many models

- 1 High-tech design
- 2 Easy user-friendly access
- 3 Freezer compartment
- 4 Blue LED interior light
- 5 Robust DRAWER mechanism
- 6 Off-shore lock for perfect closure at any time
- 7 World Premiere: first frost-free feature for the DR 55 and DR 65



Please ask for your Refrigerator CD for customised solutions. Create your own refrigerator or freezer in 6 steps!

## Product Overview: Isotherm DRAWER Marine Refrigerators and Freezers

Type	Volume (l)	Dimensions H x W x D (mm) <sup>1</sup>	Available with ASU	Weight (kg)	Power consumption* W/24 hours	Danfoss compressor type
DR 49 INOX	49	510 x 405 x 520	No	21	340	BD35F
DR 49 GLASS	49	510 x 405 x 520	No	21	340	BD35F
DR 55 frost-free FREEZER INOX	55	540 x 470 x 520	No	31	600	BD35F
DR 55 frost-free FREEZER GLASS	55	540 x 470 x 520	No	31	600	BD35F
DR 65 INOX	65	540 x 470 x 520	No	24	360	BD35F
DR 65 GLASS	65	540 x 470 x 520	No	31	360	BD35F
DR 65 frost-free INOX	65	540 x 470 x 520	No	31	340	BD35F
DR 65 frost-free GLASS	65	540 x 470 x 520	No	31	340	BD35F
DR 105 INOX	105	520 x 520 x 590	No	34	400	BD50F
DR 160 INOX COMBO**	155	860 x 615 x 545	No	40	1100	-
DR 190 INOX	190	795 x 900 x 560	No	42	700	BD50F

\* Power consumption in operation in 12 volt with +6°C in the refrigeration space, ambient temperature +22°C.

\*\* Power supply 220 V AC or 110 V AC; 50-60 Hz

<sup>1</sup> With the option of universal AC/DC the depth increases by 20 mm.

All DRAWER fridges (except the DR 160) are 12/24 DC with the option of the universal AC/DC kit. The DR 160 is either 220 V AC 50 Hz or 115 V AC 60 Hz.

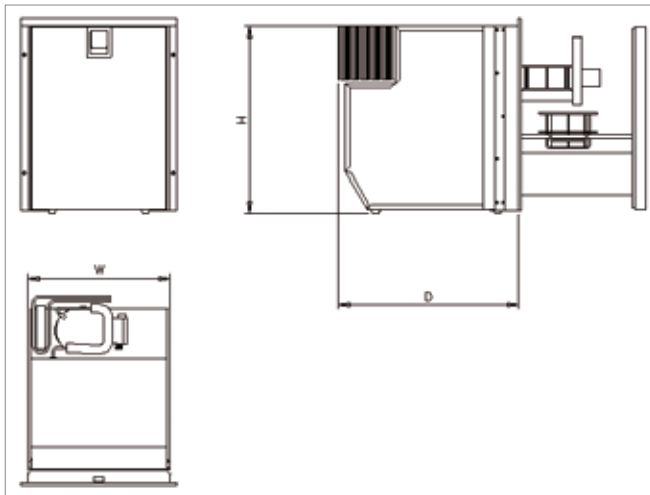

The DRAWER 160 combo offers an all-in-one solution, providing a fridge, a freezer and an ice-maker in one system.

### Outstanding design possibilities with glass doors option:

GLASS line colours include Navy blue, grey, white and black. Customised colours available on request.



Advice · Installation · Service